

# Iris Gateway™

Interoperability Starts with Device Connectivity

Automatic data transfer from medical devices into Electronic Medical Records (EMRs) could improve productivity and reduce the likelihood of transcription errors.<sup>1</sup> Existing approaches for device connectivity can clutter the patient room, burden IT management, and increase the complexity and cost of care. Masimo Iris™ and Root® seek to simplify connectivity across the continuum of care.



**3<sup>rd</sup> Party Standalone Devices\*** can silo valuable patient data

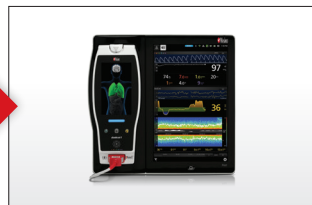

**Root** patient monitoring connectivity hub for 3<sup>rd</sup> party standalone device data



**Iris Gateway** converts all Masimo and 3<sup>rd</sup> party standalone device data into HL7



**EMR** – Iris Gateway interfaces with EMRs for documentation of device data



# Iris Gateway bridges the gap between device data generated at the patient bedside and documentation in patient data management systems such as EMRs.

## Connectivity

- > Root integrates patient monitoring and connectivity. Iris Gateway interfaces with hospital Admit Discharge Transfer (ADT) systems to allow clinicians to associate patients to their data directly from Root.
- > Iris Gateway converts device-specific communication protocols into HL7 for easy documentation in EMRs.

## Cost Reduction

- > Masimo's unique approach to device connectivity leverages existing hardware and infrastructure to reduce the cost of connectivity.
- > Iris Gateway offers connectivity at a competitive per bed cost.

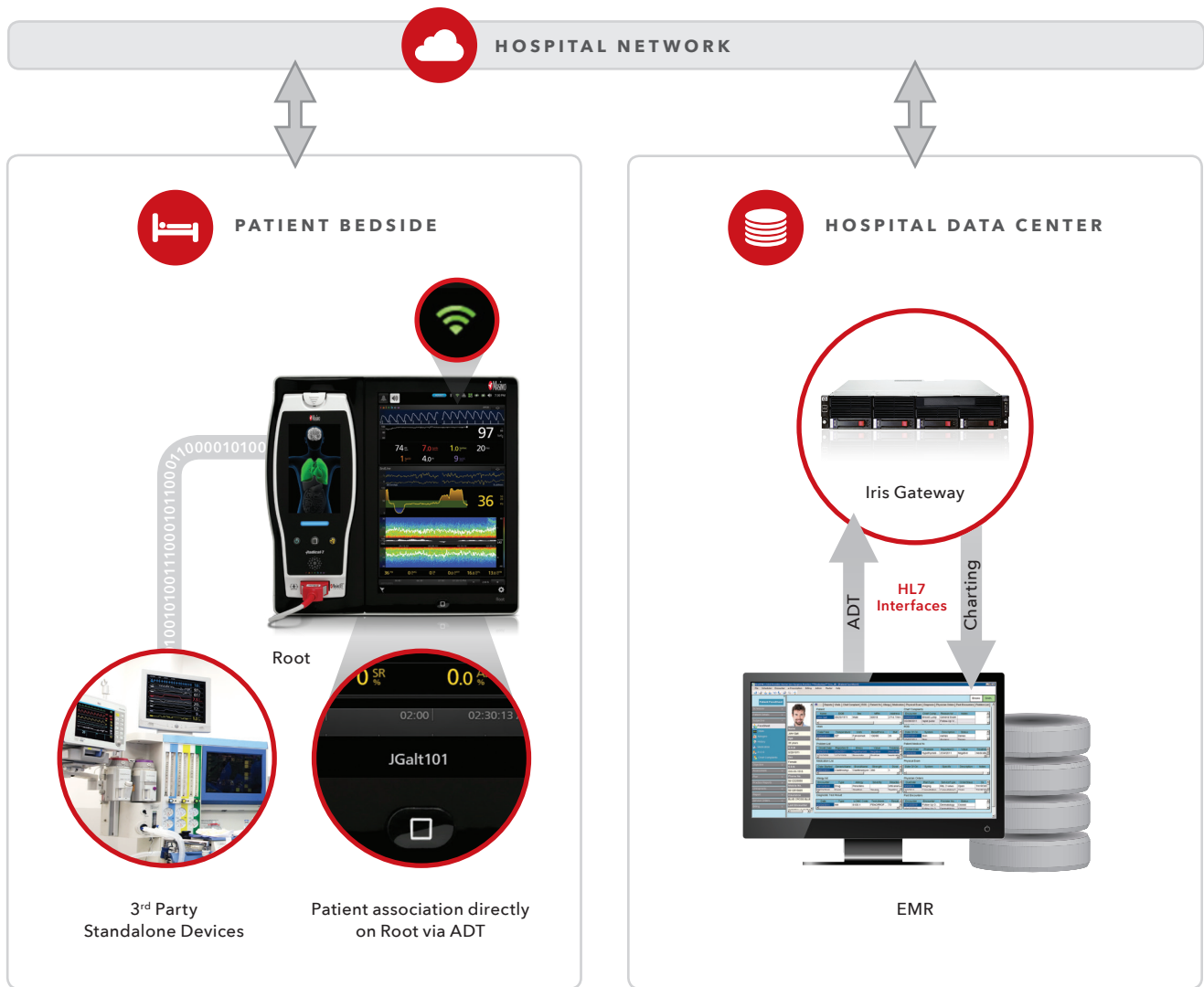

<sup>1</sup> The Value of Medical Device Interoperability. West Health Institute. 2013. \* 3rd party standalone devices with appropriate networking capabilities can communicate directly with Masimo's Iris Gateway.

Caution: Federal (USA) law restricts this device to sale by or on the order of a physician. See instructions for use for full prescribing information, including indications, contraindications, warnings, and precautions.

**Masimo U.S.**  
Tel: 1 877 4 Masimo  
info-america@masimo.com

**Masimo International**  
Tel: +41 32 720 1111  
info-international@masimo.com

